

A SECTION
SCALE @ A1: 1:50
SCALE @ A3: 1:100

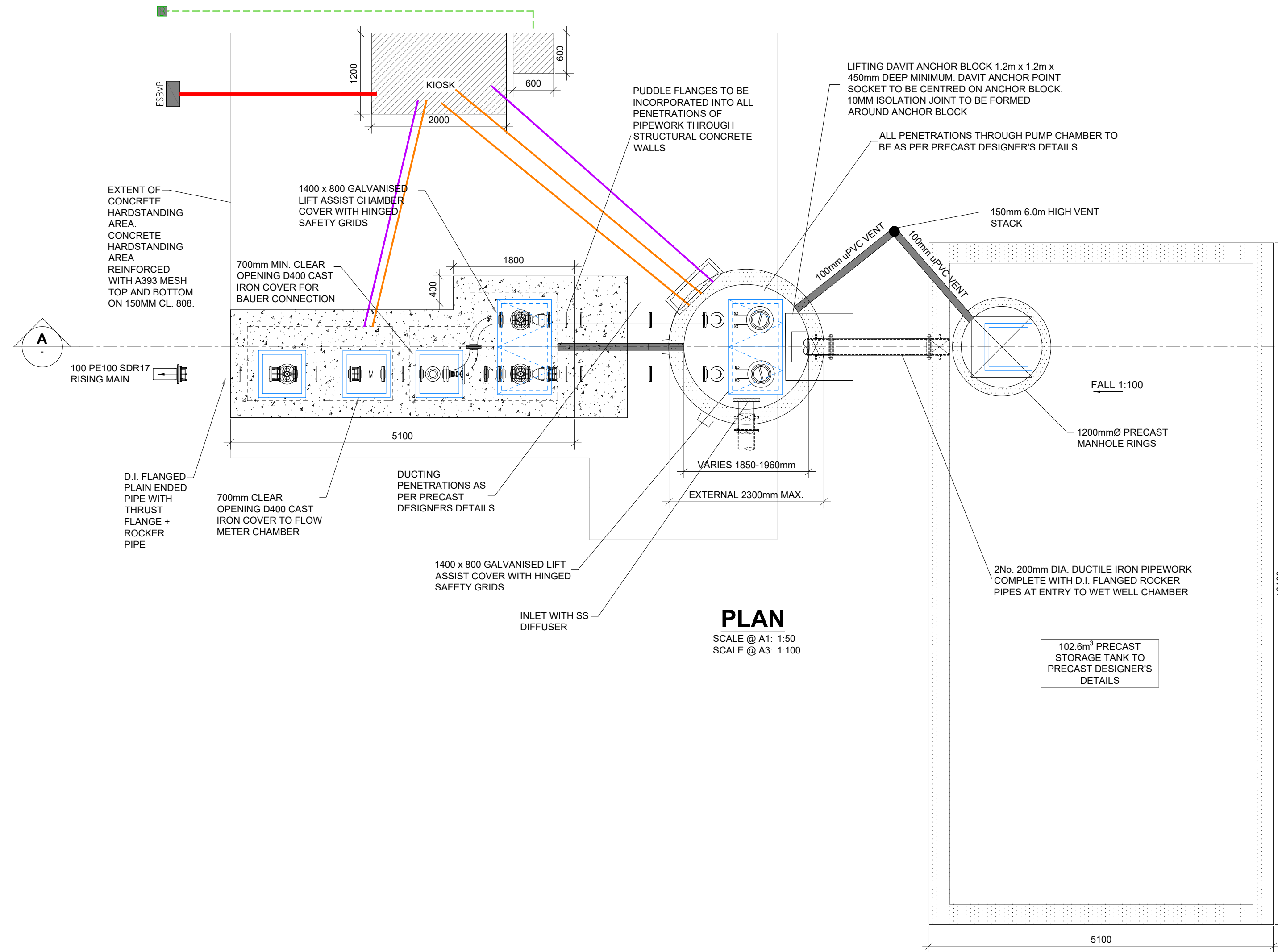

PLAN
SCALE @ A1: 1:50
SCALE @ A3: 1:100

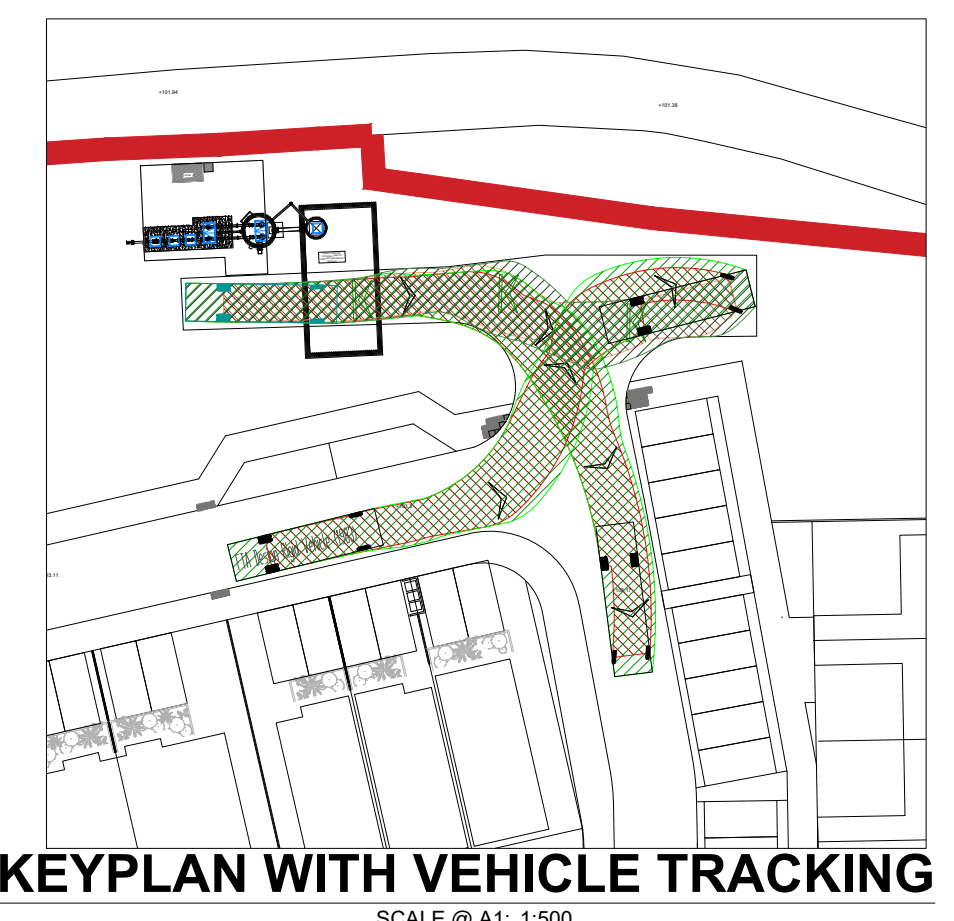

KEYPLAN WITH VEHICLE TRACKING
SCALE @ A1: 1:500
SCALE @ A3: 1:1000

- NOTES:**
1. FOUL PUMPING STATION TO BE CONSTRUCTED IN ACCORDANCE WITH IRISH WATER DETAILS & CODE OF PRACTISE
 2. ALL KIOSKS AND COVERS TO BE LPS 1175 SR3 SECURITY RATED.
 3. C250 RATED 14x8 SAFETY LIFT ASSIST ACCESS COVERS (LPS 1175 SR3 SECURITY RATED) COMPLETE WITH FALL ARREST CAGES TO BE PROVIDED ON WET WELL AND VALVE CHAMBER. ALL OTHER LIDS TO BE CAST IRON D400 RATED WITH CLEAR OPENING OF 700mm x 700mm.
 4. PRECAST ELEMENTS BE SURROUNDED IN CONCRETE AS SHOWN.
 5. 45 DEGREE BENCHING TO BE PROVIDED IN WET WELL TOWARDS PUMPS.
 6. DN25 OVERFLOW AND RETURN PIPE TO BE INSTALLED WITH ROCKER PIPES FITTED.
 7. STAINLESS STEEL DIFFUSER TO BE PROVIDED ON MAIN GRAVITY INLET TO WET WELL SUMP.
 8. HAND OPERATED PENSTOCK INLET VALVE TO BE PROVIDED IN FINAL FOUL MANHOLE (F1.10) UPSTREAM OF WET WELL.
 9. MIN. 500mm STRAIGHT PIPE REQUIRED PRIOR AND POST F.M. BEFORE ANY VALVES. ISOLATION VALVE TO BE PROVIDED AFTER FM PRIOR TO RISING MAIN.
 10. PUBLIC STREET LIGHTING FOR THE DEVELOPMENT SHALL PROVIDE MIN. 100 LUX AT GROUND LEVEL OF PUMPING STATION.
 11. RISING MAIN TO BE CONSTRUCTED IN ACCORDANCE WITH IRISH WATER'S STANDARD DETAILS AND CODE OF PRACTICE FOR WASTEWATER INFRASTRUCTURE.
 12. RISING MAIN DISCHARGE MANHOLE TO BE CONSTRUCTED IN ACCORDANCE WITH IRISH WATER DRAWING STD-WW-29

NOTES

1. THIS DRAWING IS TO BE READ IN CONJUNCTION WITH ALL ENGINEERS & ARCHITECT'S DRAWINGS FIGURED DIMENSIONS ONLY (NOT SCALING) TO BE USED. WHERE A CONFLICT OF INFORMATION EXISTS OR IF IN ANY DOUBT - ASK!
2. CONSULTANTS TO BE INFORMED IMMEDIATELY OF ANY DISCREPANCIES BEFORE WORK PROCEEDS.

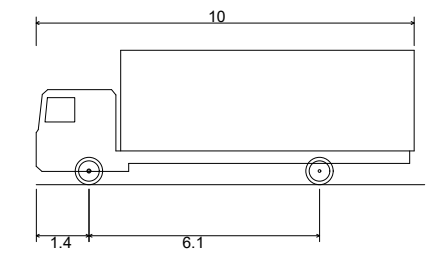

FTA Design 13/18 Tonne Rigid Vehicle (2016)
Overall Length 10.000m
Overall Width 2.550m
Overall Body Height 3.645m
Min Body Ground Clearance 0.440m
Track Width 2.470m
Lock-to-lock time 3.00s
Curb to Curb Turning Radius 11.000m

VEHICLE PROFILE

SCALE @ A1: NTS
SCALE @ A3: NTS

LEGEND

- ESB DUCT (125mm)
- POWER DUCT (100mm)
- SIGNAL DUCT (100mm)
- ESB MINI-PILLAR
- 1" WATERMAIN CONNECTION AND BOUNDARY BOX

PL1	05.03.21	ISSUED FOR PLANNING	PR	POD	SM
P1	25.09.20	ISSUED FOR SuDS AUDIT	PR	POD	SM
ISSUE	DATE	DESCRIPTION	DRN	ORIG	P.E.

PLANNING

BM Dublin Office: Sandwith House, 52-54 Lower Sandwith Street, Dublin 2, Ireland. Tel: (01) 677 3200 Fax: (01) 677 3164
London Office: 12 Mill Street, London SE1 2AY, United Kingdom Tel: (0044) 084 5413 2722
BARRETT MAHONY Consulting Engineers, Civil, Structural, Project Management. E-mail: bmce@bmce.ie Web: www.bmce.ie

The Institution of Structural Engineers **ACEI** **IFEC** International Federation of Consulting Engineers

CLIENT: **CAIRN HOMES PROPERTIES LTD.**

PROJECT TITLE COOKSTOWN ROAD, ENNISKERRY, CO. WICKLOW	BM PROJECT No. 18243
---	--------------------------------

MODEL REFERENCE 18243-BMD-ZZ-00-DR-C-1211	MODEL REV. P1	SUITABILITY S0
---	-------------------------	--------------------------

DRAWING TITLE: **PROPOSED FOUL PUMPING STATION DETAILS**

DRAWING No. 18243-BMD-ZZ-00-DR-C-1211	ISSUE PL1
---	---------------------